



Enhance Your Comfort *Outdoors*

Tungsten Smart-Heat™ Collections Guide

Contents

Design & Integration.....	6
Selecting Your Fuel Source.....	7
Tungsten Smart-Heat Electric.....	8
Tungsten Smart-Heat Gas.....	14
Tungsten Smart-Heat Portable.....	20
Controls.....	25
Performance.....	26
Sustainability.....	27
Collection Lineup.....	28

Bromic is globally recognized as the leader in outdoor heating.





Tungsten Electric Heater

6000W Series Heater
Ceiling Mounted

Immense *Power.* *Bold* Design.

The industry standard in outdoor heating.

The award-winning Tungsten Smart-Heat collection is the true powerhouse of all Bromic collections, combining high-performance stainless-steel construction with unparalleled radiant heating strength. Available in both gas and electric fuel sources with complete versatility in mounting options including portable, wall, ceiling, and recessed, the Tungsten collection offers efficient radiant heating built with a timeless industrial design style.

Looking for an outdoor heater that will get the job done in any environment? You've found it.





Tungsten Gas

300 Series (26,000
BTU) Wall Mounted

Design + Integration

The Tungsten collection is manufactured with a high-temperature coating and durable stainless-steel construction to ensure longevity of use. Its unique honeycomb mesh surface and interior quartz elements project powerful directional heat keeping you and your guests warm all year round.

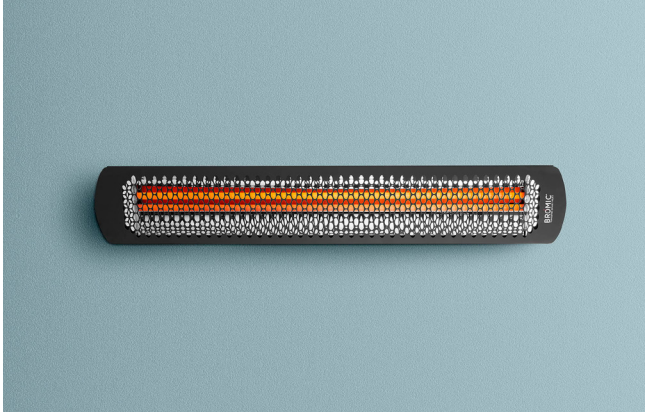

Tungsten Electric

With four models ranging from 2000W to 6000W, each Tungsten Electric heater provides an even flow of warmth to outdoor spaces of up to 160ft². Available in both black and white with a variety of mounting options including wall, ceiling, and recessed, this high-powered electric heater is suitable for all environments.

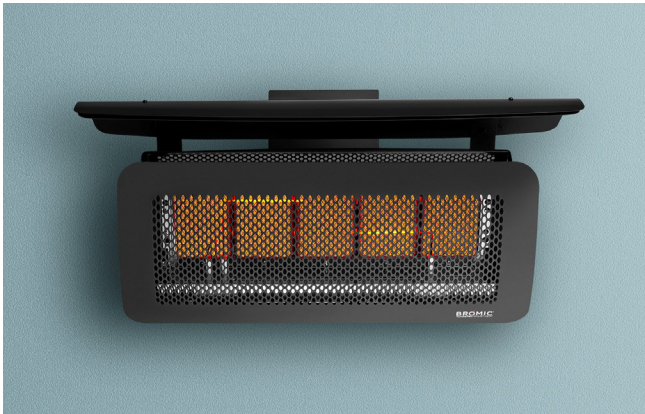

Tungsten Gas

Available in 26,000 BTU and 43,000 BTU heating power in either natural gas (NG) or propane (LPG) fuel sources, this powerful radiant heater can quickly heat outdoor areas of up to 215ft². Whether mounted from the wall or ceiling, its easy pivot arm allows for greater positioning and directional heat control.



Tungsten Portable

Ideal for areas without a structure, the award-winning Tungsten Portable's modular construction and built-in wheels allow for ease of maneuverability and the anti-tilt shutoff keeps safety top of mind. Conveniently adjust heat output for precise levels of comfort using either the natural gas (NG) or propane (LPG) fuel source option.

Selecting Your Fuel Source

As the only manufacturer that offers outdoor heating solutions in natural gas, propane, and electric fuel sources, the fuel selection criteria can offer important advantages in your specific application. Here are three areas to consider in your design plan.

1

Climate

The physical location and placement of your heaters can leverage significant efficiency based on the fuel type.

TUNGSTEN ELECTRIC

- Ideal for enclosed and semi-enclosed applications.
- Can be dimmed for precise comfort.

TUNGSTEN GAS

- Ideal for colder environments with high ceilings and big power requirements.
- Requires ventilation.
- Is not dimmable.

TUNGSTEN PORTABLE

- Ideal for outdoor spaces without a structure.
- Requires ventilation.
- LPG fuel source is dimmable. Natural gas is not.

2

Clearances

How you integrate your heaters into your space is largely dictated by the clearances each fuel source requires. No matter the fuel source, a minimum mounting height of 96" is required in clearance from the floor to the bottom surface of the heating solution.

TUNGSTEN ELECTRIC

- Can be recessed using the Tungsten Electric Recessing Kit.

TUNGSTEN GAS

- Requires 14" of ceiling clearance with optional heat reflector & 36" of vertical clearance without reflector.

TUNGSTEN PORTABLE

- Requires 36" of ceiling clearance as well as a 36" clearance from each side.

3

Cost

Operational fuel costs can have a significant impact on high use applications like Restaurants and Hospitality. Fuel costs can vary by locale.

TUNGSTEN ELECTRIC

- ±\$1.84 per hour to heat a 400ft² patio.

TUNGSTEN GAS

- LPG: ±\$2.07 per hour to heat a 400ft² patio.
- Natural Gas: ±\$1.06 per hour to heat a 400ft² patio.

TUNGSTEN PORTABLE

- LPG: ±\$2.07 per hour to heat a 400ft² patio.
- Natural Gas: ±\$1.06 per hour to heat a 400ft² patio.

Tungsten Smart-Heat Electric

Available in black and white, our Tungsten Smart-Heat Electric series combines market leading radiant heat with a stylish, industrial design to heat outdoor spaces of up to 160ft². Manufactured with high-temperature coating, stainless-steel construction and unique honeycomb mesh surface, precise heat is distributed with a warm, soothing glow. Complete with a variety of mounting options including wall, ceiling and recessed and offered in a variety of heat outputs ranging from 2000W to 6000W, this heater sets the industry standard and can be tailored for all environments.



Specifications

Reference the specification guide below to help you select the correct solution for your needs.

MODEL NUMBER	2000 SERIES	3000 SERIES	4000 SERIES	6000 SERIES
PRODUCT CODE	BH0420030	BH0420031	BH0420032 BH0420034 BH0420012	BH0420033 BH0420035 BH0420013
FUEL TYPE	ELECTRIC	ELECTRIC	ELECTRIC	ELECTRIC
COLOR	BLACK	BLACK	BLACK WHITE	BLACK WHITE
HEAT AREA	65ft ²	100ft ²	130ft ²	160ft ²
RATED CURRENT**	240V/8.3A 208V/9.62A 277V/7.22A	240V/12.5A 208V/14.42A 277V/10.83A	240V/16.6A 208V/19.23A 277V/14.44A	240V/25A 208V/28.85A 277V/21.66A
MINIMUM FLOOR CLEARANCE	WALL 72" CEILING 96"	WALL 72" CEILING 96"	WALL 72" CEILING 96"	WALL 72" CEILING 96"
MOUNTING OPTIONS				
CEILING MOUNT	✓	✓	✓	✓
CEILING RECESS KIT PRODUCT CODES	BH8180010	BH8180011	BH8180010	BH8180011
WALL MOUNT	✓	✓	✓	✓
RECESSED FLUSH MOUNT	✓	✓	✓	✓
CEILING POLE MOUNT	✓	✓	✓	✓
TUBE SUSPENSION KIT (36") PRODUCT CODE	BH8180012	BH8180012	BH8180012	BH8180012
FREESTANDING	-	-	-	-
CONTROL OPTIONS				
ON OFF	✓	✓	✓	✓
ON OFF PRODUCT CODE	BH3130010-1	BH3130010-1	BH3130010-1	BH3130010-1
DIMMER	✓	✓	✓	✓
DIMMER PRODUCT CODE	BH3130011-1	BH3130011-1	BH3130011-1	BH3130011-1
MASTER REMOTE *	✓	✓	✓	✓
MASTER REMOTE PRODUCT CODE	BH3130012	BH3130012	BH3130012	BH3130012

Measurements displayed within this catalog are minimum requirements for installation. Bromic takes no responsibility for incorrect or non-compliant installations. All measurements in this catalog are displayed in inches.

** Available in varying voltages: 240V, 208V and 277V

* Control up to six zones of heaters with unlimited heaters per zone from a single control. Works with dimming controllers. Control operates within 100ft of heaters.

Dimensions

PRODUCT MEASUREMENTS

2000W & 4000W

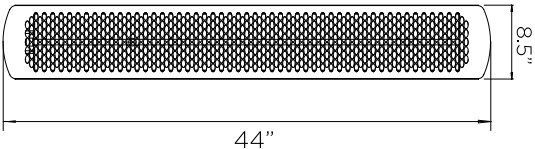

3000W & 6000W

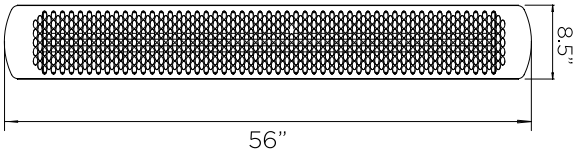

CEILING RECESS

CEILING RECESS FRAME 2000W & 4000W

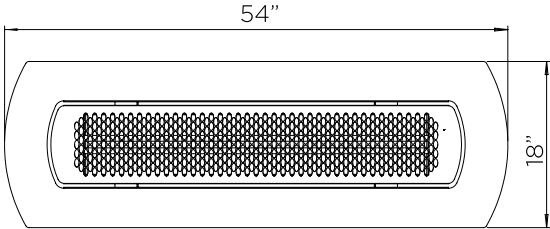

CEILING RECESS FRAME 3000W & 6000W

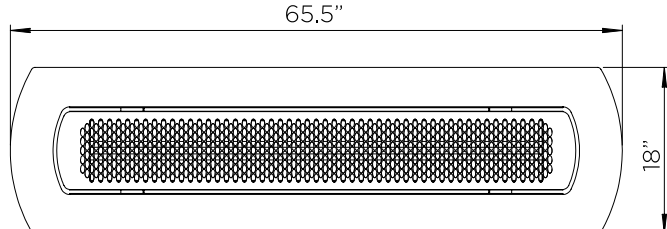

MINIMUM CEILING CAVITY

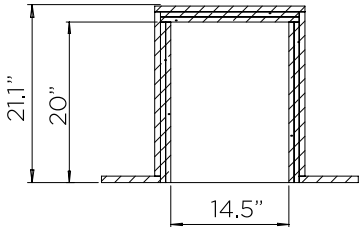

2000W & 4000W

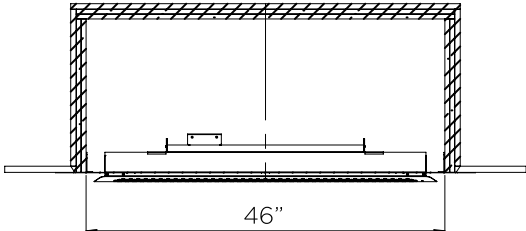

3000W & 6000W

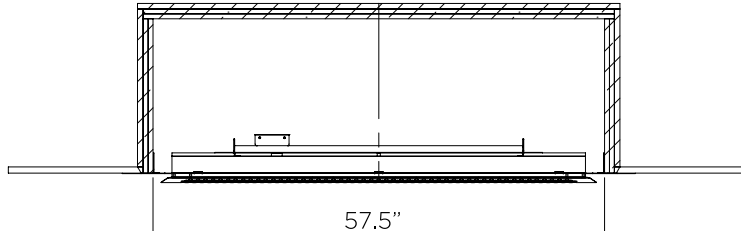

CEILING & WALL MOUNT CLEARANCE

CEILING MOUNT CLEARANCE

2000W & 3000W

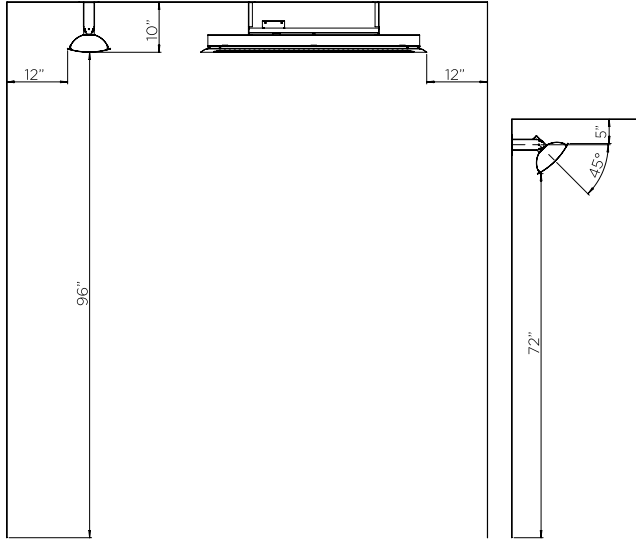

CEILING MOUNT CLEARANCE

4000W & 6000W

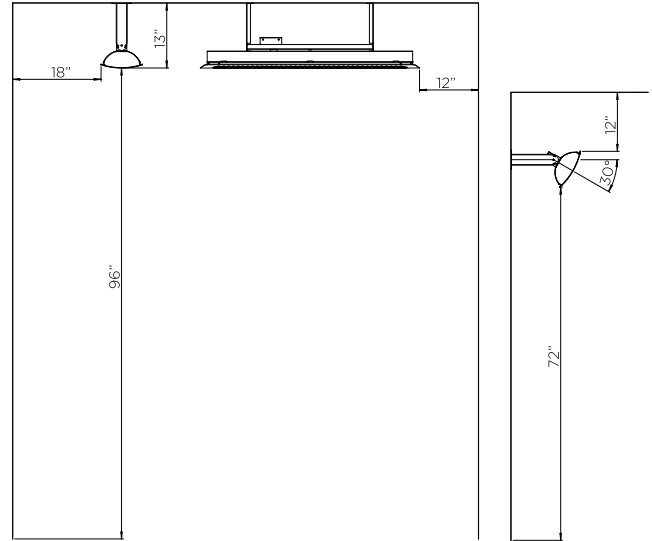

CEILING POLE CLEARANCE

2000W & 3000W

4000W & 6000W

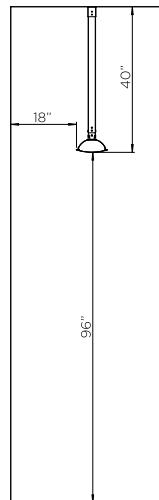
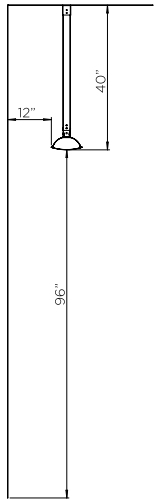

WALL BRACKET (INCLUDED)

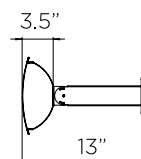
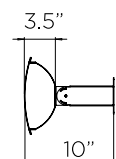

Heat Distribution

HEAT AREA

2000W SERIES

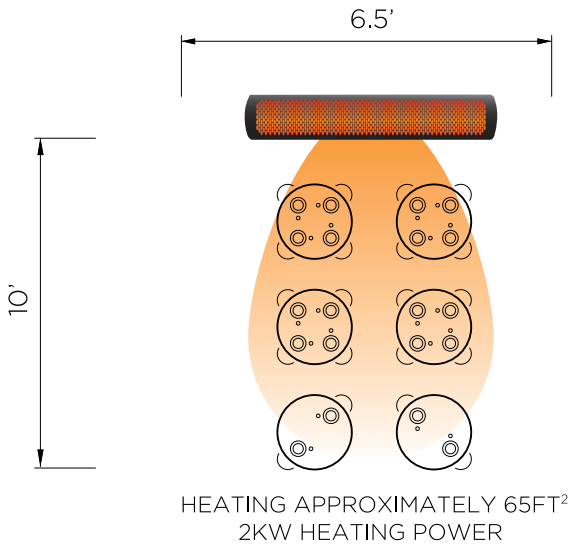

3000W SERIES

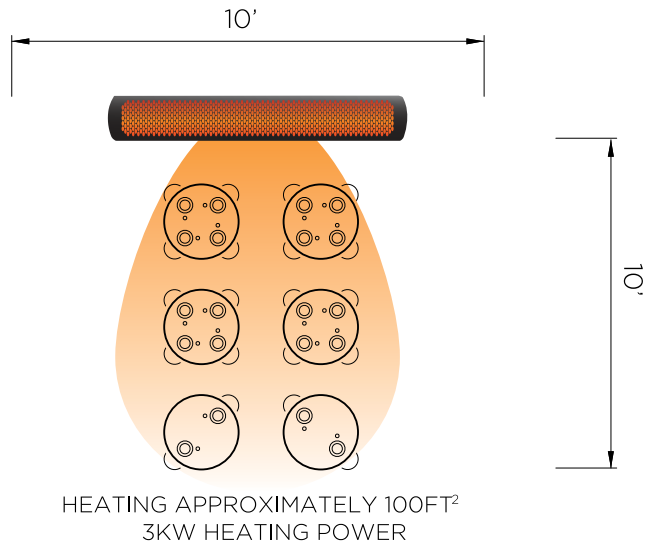

4000W SERIES

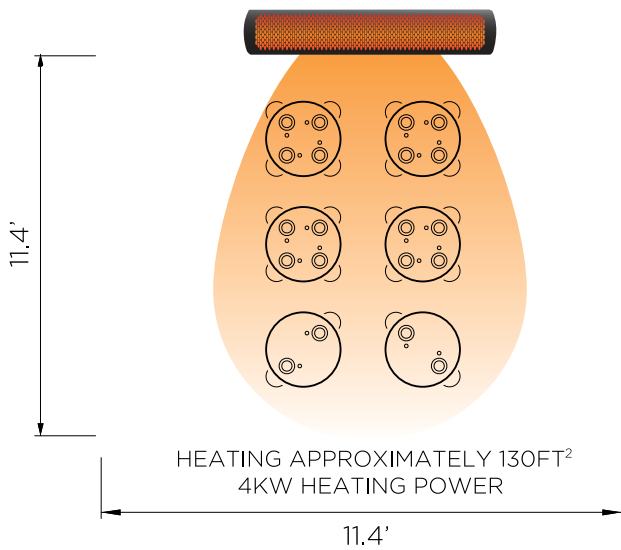

6000W SERIES

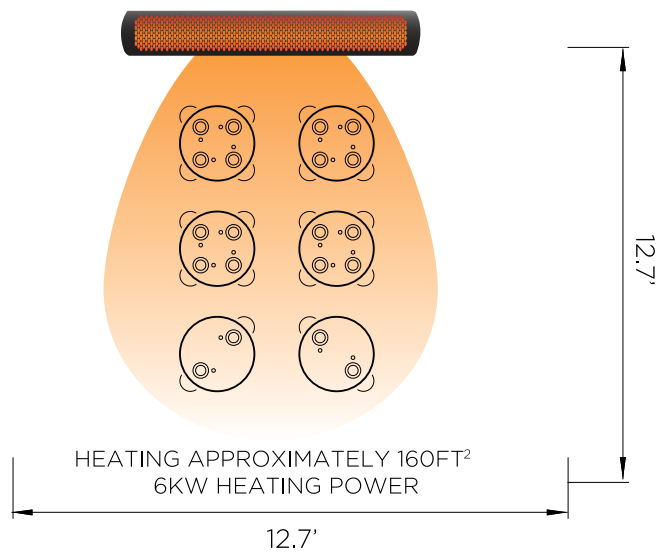

*Heat area dependent on ambient temperature and wind. Optimum conditions experienced at approx 60°F and in a low wind covered environment.

Features & Benefits

Built for Durability

Manufactured with high-temperature coating, stainless-steel construction for longevity of use

Total Mounting Flexibility

Available in wall, ceiling or recessed mounting options.

Precise Heat

Provides precise directional heat with 15-45 degree rotation angle varying by model

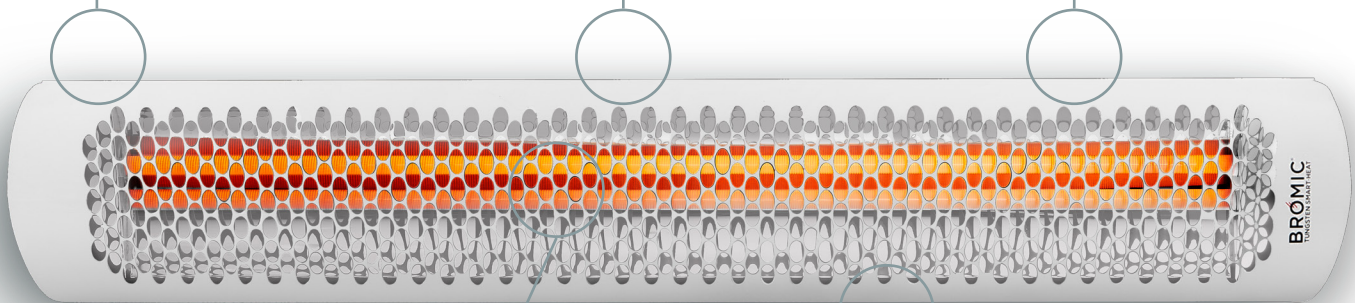

Smart Heat Technology

Thick steel coil housed in translucent fused quartz offers high-heat output backed by an industry leading 7-year warranty

Unique Design

Honeycomb mesh surface facilitates even heat distribution

Tungsten Smart-Heat Gas

With its curved surface and durable stainless steel engineered body, the Tungsten Gas heater is a work-horse in providing powerful radiant heat. Available in matte black, with two power output levels (26,000 BTU & 43,000BTU), and in both natural gas (NG) and propane (LPG) fuel sources, this powerful heater is ideal for well-ventilated large spaces and colder climates. The easy pivot arm allows for greater positioning and directional heat control of up to 215ft² with exceptional wind resistance of up to 8mph. Experience year-round warmth with this versatile heater featuring wall and ceiling mounting options to fit seamlessly into any space.



Specifications

Reference the specification guide below to help you select the correct solution for your needs.

MODEL NUMBER	300 SERIES	500 SERIES
PRODUCT CODE	BH0210002-1 BH0210001-1	BH0210004-1 BH0210003-1
FUEL TYPE	LPG NG	LPG NG
COLOR	BLACK	BLACK
HEAT AREA	160ft ²	215ft ²
ELECTRICAL CONNECTION	110V/2A	110V/2A
MINIMUM FLOOR CLEARANCE	96"	96"
OUTPUT	26,000 BTU	43,000 BTU
MOUNTING OPTIONS		
CEILING MOUNT	✓	✓
WALL MOUNT	✓	✓
RECESSED FLUSH MOUNT	-	-
CEILING POLE MOUNT	✓	✓
FREESTANDING	-	-
CONTROL OPTIONS		
ON OFF	✓	✓
ON OFF PRODUCT CODE	BH3130010-1	BH3130010-1
DIMMER	-	-
MASTER REMOTE	-	-

Measurements displayed within this catalog are minimum requirements for installation.

Bromic takes no responsibility for incorrect or non-compliant installations.

All measurements in this catalog are displayed in inches.

Dimensions

PRODUCT MEASUREMENTS

500 SERIES

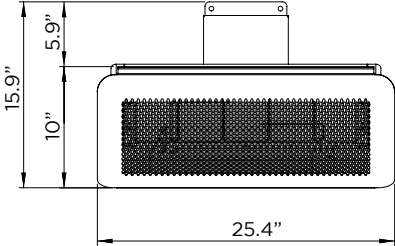

300 SERIES

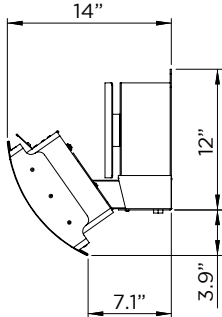
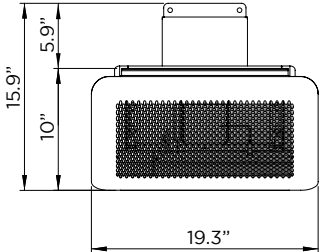

PRODUCT MEASUREMENTS WITH HEAT DEFLECTOR

500 SERIES

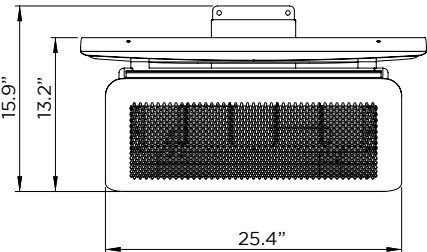

300 SERIES

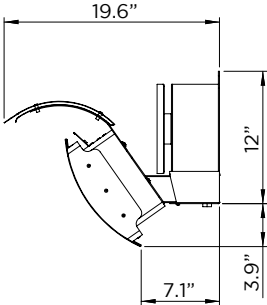
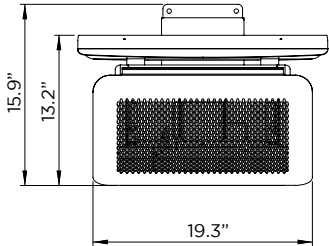

CEILING & WALL MOUNT CLEARANCE

WALL MOUNT CLEARANCE

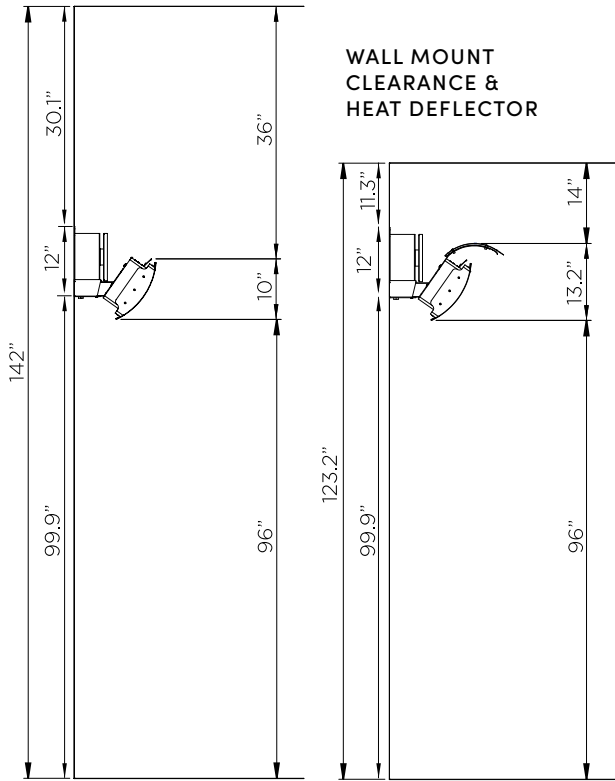

CEILING MOUNT CLEARANCE

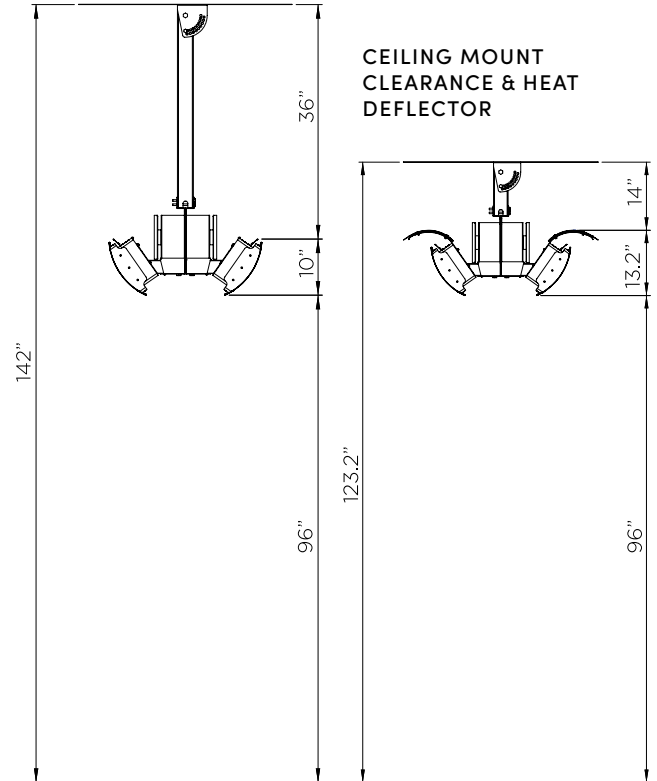

WALL BRACKET

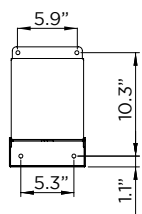

Heat Distribution

HEAT AREA

500 SERIES

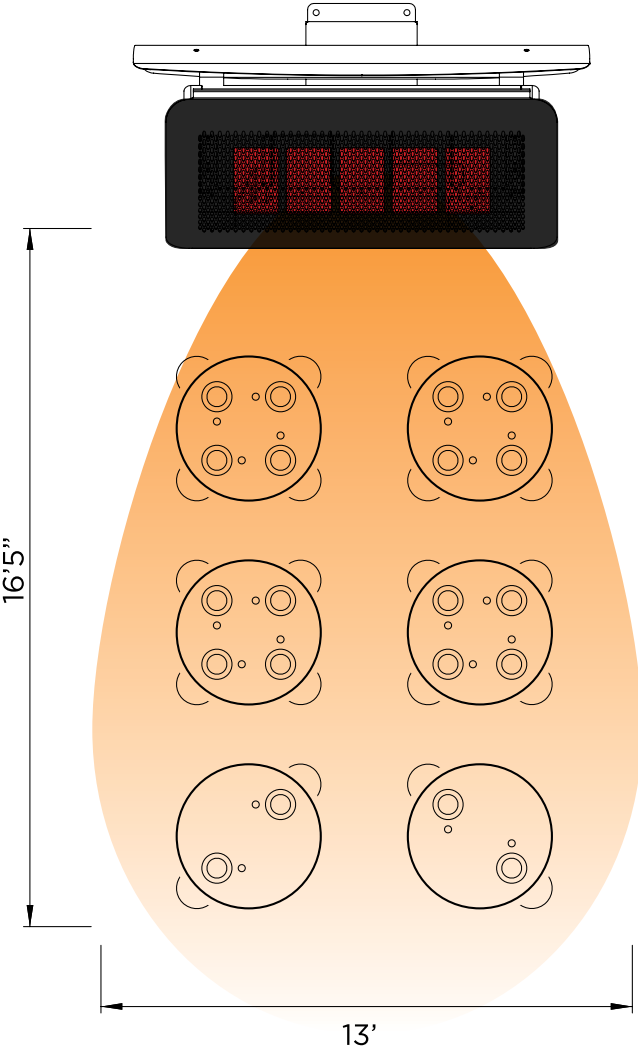

HEATING APPROXIMATELY 215FT²
43,000 BTU HEATING POWER

300 SERIES

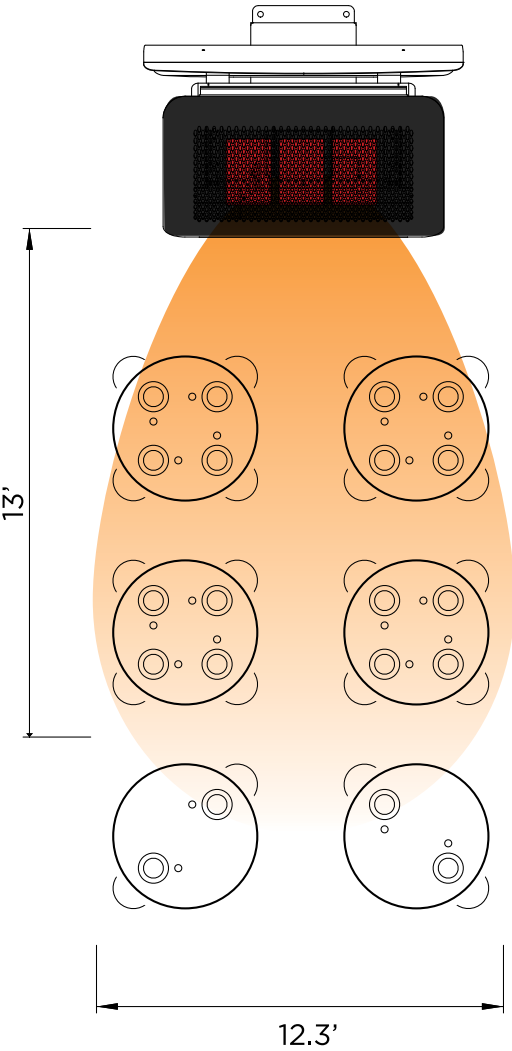

HEATING APPORXIMATELY 160FT²
26,000 BTU HEATING POWER

*Heat area dependent on ambient temperature and wind. Optimum conditions experienced at approx 60°F and in a low wind covered environment.

Features & Benefits

Total Mounting Flexibility

Furnished with a complimentary wall mount with control housing, and available with ceiling mounting options ranging from 9.69" to 41.18"

Instant Comfort

Instantaneous ignition, whenever you require it, without the need for a pilot light

Precise Heat

Ability to rotate 25 degrees on each side, allowing for directional heat distribution

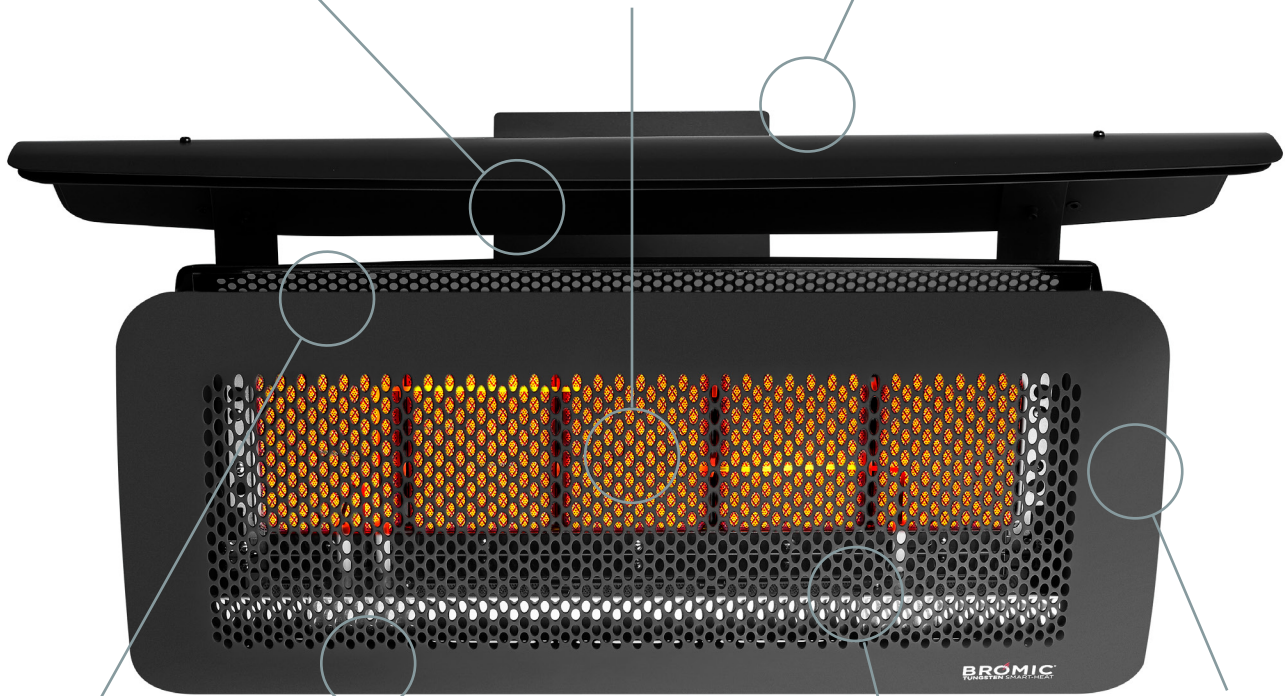

Enhanced Safety Features

Integrated "Flame Failure Safety Shut-off Control" turns the heater off immediately should it not re-ignite

High Performance Construction

Manufactured with a matte black stainless-steel body and slow-release ceramic burners for efficient heat output

Patented Performance

Smart heat technology & superior wind resistance

Unique Design

Honeycomb mesh surface enables precise heat distribution

Tungsten Smart-Heat Portable

Featuring an award-winning matte black finish, with a modular and maneuverable design, this powerful portable heater is the ideal heating solution for locations without a structure. Available in both natural gas (NG) and propane (LPG) fuel sources, with a heat output of 28,500 BTU, this heater creates comfortable environments heating areas of up to 215ft². Three times more efficient than traditional mushroom heaters, this portable heater easily overcomes winds of up to 8mph and wastes little to no energy thanks to its use of directional heat, making sure the heat ends up exactly where it's needed.



Specifications

Reference the specification guide below to help you select the correct solution for your needs.

MODEL NUMBER	
PRODUCT CODE	BH0510001 BH0510005
FUEL TYPE	LPG NG
COLOR	BLACK
HEAT AREA	215ft ²
ELECTRICAL CONNECTION	-
MINIMUM CEILING CLEARANCE	36"
OUTPUT	38,500 BTU
MOUNTING OPTIONS	
CEILING MOUNT	-
WALL MOUNT	-
RECESSED FLUSH MOUNT	-
CEILING POLE MOUNT	-
FREESTANDING	✓
CONTROL OPTIONS	
ON OFF	-
DIMMER	-
MASTER REMOTE	-
ADDITIONAL OPTIONS	
HEATER COVER PRODUCT CODE	BH3030010

Measurements displayed within this catalog are minimum requirements for installation.

Bromic takes no responsibility for incorrect or non-compliant installations.

All measurements in this catalog are displayed in inches.

Dimensions

SIDE & FRONT VIEW

SIDE VIEW

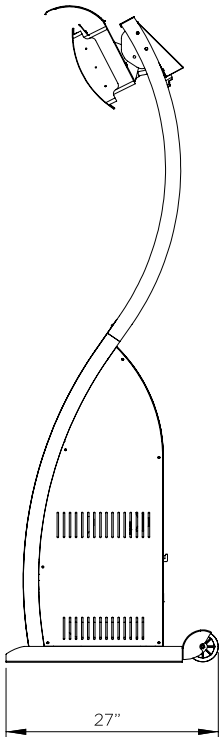

FRONT VIEW

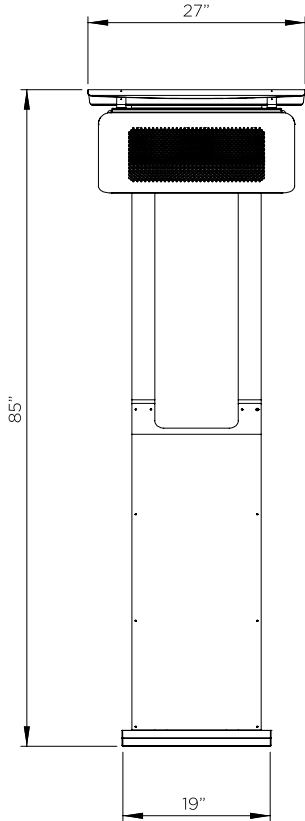

CEILING & WALL CLEARANCE

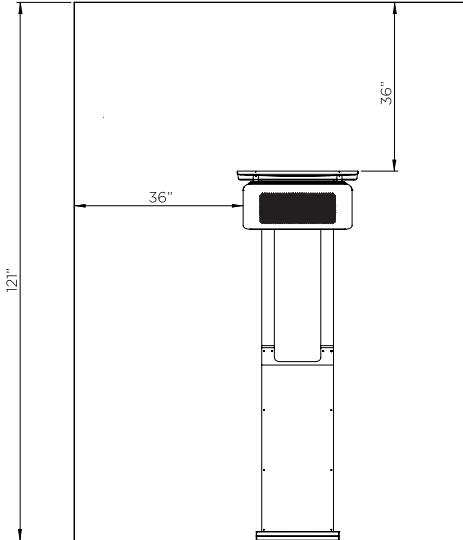
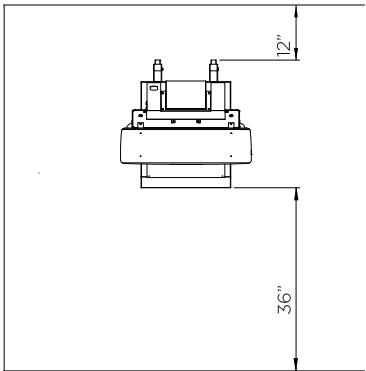

Heat Distribution

HEAT AREA

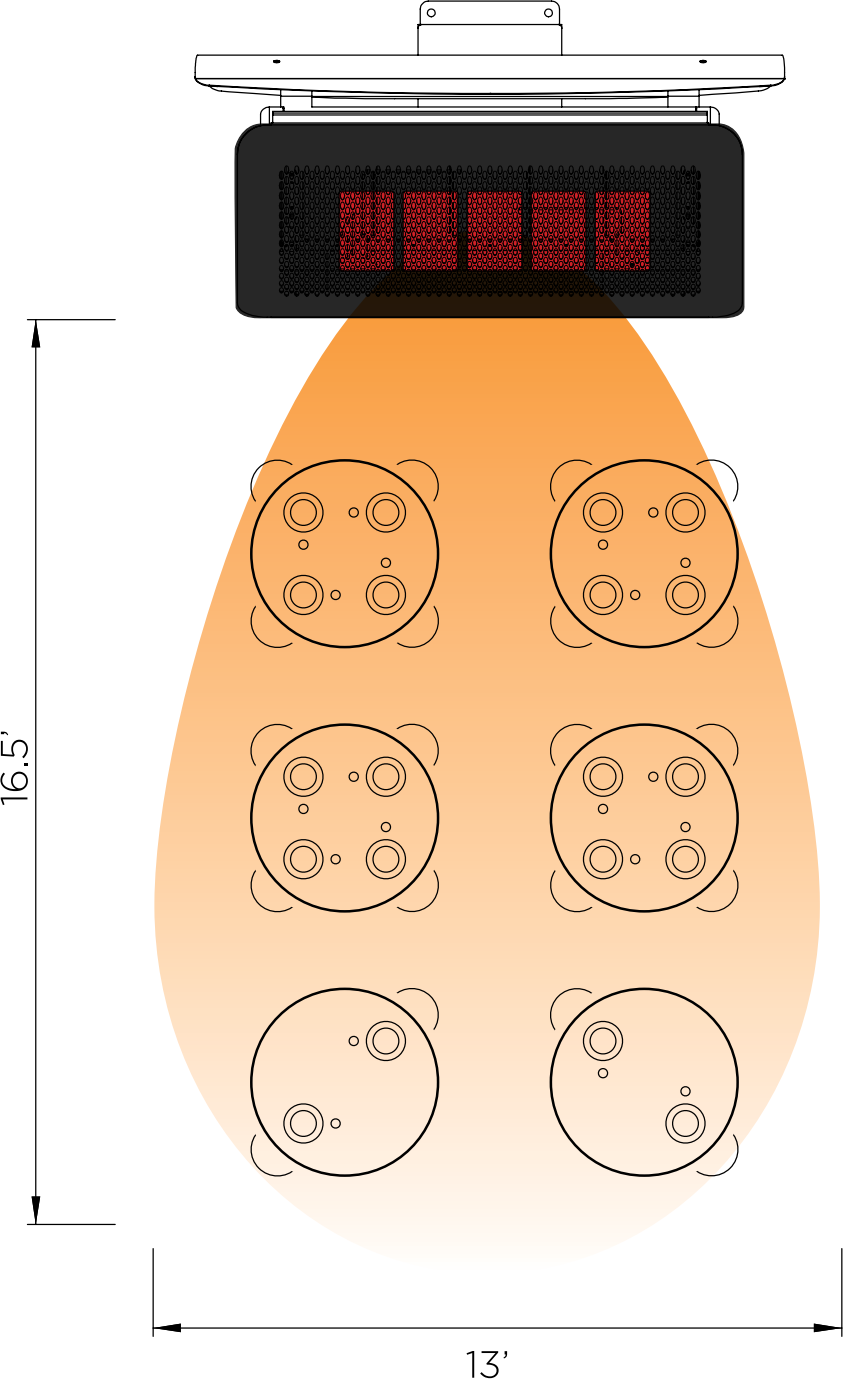

HEATING APPROXIMATELY 215FT² | 38,500 BTU HEATING POWER

*Heat area dependent on ambient temperature and wind. Optimum conditions experienced at approx 60°F and in a low wind covered environment.

Features & Benefits

Precise Heat

Provides flexibility of heat direction for precise heating

Ceramic Burners

Delivery of optimal heat with minimal heat loss is assured via high-intensity ceramic burners

Safety Feature

Anti tilt shut off keeping safety top of mind

Adjustable Heat Controls

Offers ease of operation and precise heat comfort levels

Modular Design

Easy assembly, dismantling and storage thanks to a functional and pragmatic design

Efficient Heat Output

8 hours of operating time on a single tank of propane!

Ease of Maneuverability

Easy mobility even in tighter spaces with an anti-tilt structural design and built-in wheels



Controls

Bromic's control options make the operation of your outdoor heater even more convenient. Choose from simple On/Off remotes to dimmer controls to fully integrated smart home solutions.



On/Off Controller

Bromic's independent 'On/Off' control will let you control up to two electric or four gas heaters across two separate circuits from up to 100ft away. The wireless transmitter is fully portable or can be easily mounted with the included double-sided adhesive/screws.



Wireless Dimmer Controller

Move beyond the base-model wireless controller with the Bromic Dimmer Controller. Suitable for our electric heaters, the dimmer control provides the ability to precisely adjust the electric heat output in 1% increments, or quickly jump by 25% increments, from up to 100ft away.



Wireless Master Remote

Invaluable for larger venues, the Wireless Master Remote offers full control over an unlimited number of heaters in up to 6 groups within a 100ft range. Compatible with our Dimmer Controller.

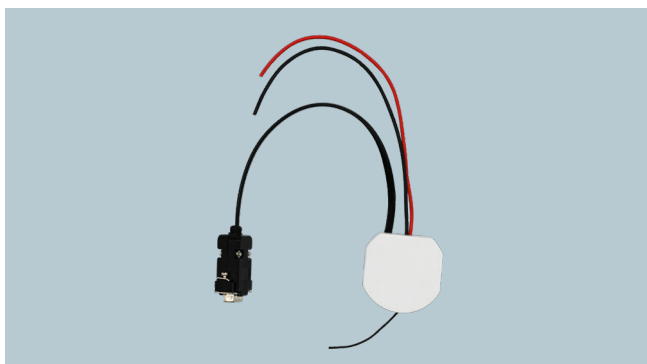

Smart-Heat Link

Pair Bromic's control options with the Smart-Heat Link to create a seamless communication between your outdoor heaters and smart home controls technology. The Bromic Smart-Heat Link requires a RS232 port and is compatible with leading home automation systems, such as Control 4, Crestron, Lutron, Nomad and many more!

Performance, Reliability & *Beauty*

Bromic outdoor heaters are recognized all over the world for superior design and performance. From luxury hotels and leading restaurants to distinguished residential outdoor kitchens and exquisite backyards, Bromic outdoor heaters deliver the comfort and ambiance needed to elevate the outdoors.

Available in our distinctive collections, every Bromic outdoor heater is constructed from premium materials to deliver outdoor heating products that provide the perfect balance of performance, reliability and beauty.



Sustainability

The environment has a heating partner.

Bromic is committed to utilizing sustainable design principles. Leveraging outdoor spaces for dining, working, and congregating is a design priority for leading architects around the world and the global pandemic has taught us that outdoor spaces are some of the safest, healthiest, and most necessary elements in both residential and commercial contexts.

The tenants of sustainability are to reduce consumption of non-renewable resources, minimize waste, and create healthy, productive environments.

SUSTAINABLE DESIGN PRINCIPLES INCLUDE THE ABILITY TO:

- Optimize site potential
- Enhance indoor environmental quality
- Minimize non-renewable energy consumption
- Optimize operational and maintenance practices
- Use environmentally preferable products

Utilizing a sustainable design philosophy encourages decisions at each phase of the design process that will reduce negative impacts on the environment and the health of the occupants, without compromising the bottom line.

We continue our commitment to building increasingly efficient outdoor heaters that don't waste energy by heating the air, but rather, heating people with radiant technology. While many competitors' heaters may last only a season or two, Bromic heaters continue to provide warmth and comfort year-after-year, even in commercial environments.



Explore our collection lineup



Eclipse

Available in seven unique mounting options, including portable, the Eclipse Smart-Heat™ Electric collection adds style, warmth and light to design-focused outdoor spaces.



Platinum

With both gas and electric models to choose from, the Platinum Smart-Heat™ collection features premium ceramic glass fascias and stainless-steel frames for a sleek and timeless look.



Tungsten

Our Tungsten Smart-Heat™ gas and electric outdoor heaters come in a stylish, industrial design with a wide selection of heat output and mounting options, including portable.





Customer feedback has been very good. Most of my customers that have been to other restaurants have commented that the heaters we have installed are the best that they have seen.

MATTHEW MATHUS

Restaurant Manager | HIDE – London, UK



Complimentary Outdoor Heating Design Service

Gas or electric? How many heaters do I need? Where should I mount them? We can help you answer each of these questions. Leverage free, yes, free—professional design services from the technical experts at Bromic Heating.

Your Dedicated Designer

Work one-on-one with a Outdoor Heating design professional from start to finish.

2D Heating Space Map

We will work with your architectural plans or site images to ensure that your space is optimally heated.

Heating Diagram

For maximum comfort and heat generation, we recommend placing the heater(s) closest to your seating areas, while ensuring compliance with our installation clearances.

*2 x BH0420033 6000W Tungsten Electric ceiling mounted with standard mounting kit.
*Minimum clearance is 3' AFF.
*3' clearance from all combustible materials: plastic, vinyl, fabric, etc. Material(s) at 3' MUST be able to withstand 249° PLUS ambient temperature.
*18' clearance from any non-combustible materials.

BROMIC HEATING

Part Order List

From mounting options to smart home controls, we'll detail exactly what you should order. We can even connect you to a retail partner if you desire.

Recommended Heating Solution

For your area, we recommend the **TUNGSTEN SMART-HEAT™ ELECTRIC 6000 BLACK**

Consumption: Tungsten Electric heaters are available for use with 220/240V. The heaters quartz element produces only mild light emission at maximum heat coverage.

- Each 6000W heater pulls 25Amps (on 220/240V)
- Elements are replaceable

PRODUCT OVERVIEW

Installation: Heaters to be mounted between 8'-10" above finished floor to optimize heat output. Heaters can be angled at 15 and 30 degrees (either side) with the mounting bracket (supplied with 4000W/6000W models).

Dimensions: 6000W (WxDxH) 56" x 8.5" x 3.5" (Dual Element)

Controls:

- Heaters can be hard-wired to a wall switch (without remote control & controller)
- Remote Control (optional) Each heater can be remote controlled. We offer two options:
 - **Option 1:** Remote Dimmer Control provides full incremental heat output (from 100%-0%) with remote control buttons pre-set at 100%, 75%, 50%, 25%. Each Remote Dimmer includes a Controller Box to be hard-wired into a heater. Each Remote Dimmer + Controller can accommodate a maximum of 6000W for the same family of heaters. Tungsten Electric Dual element heaters (4000W and 6000W) are considered as individual families. (i.e. One Remote Dimmer + Controller will not work with 4000W and 2000W heater)
 - **Option 2:** ON/OFF Remote Control - controls two heaters in an ON/OFF mode for the 2000W and 3000W. For the 4000W and 6000W it allows a high/low

[CLICK HERE TO WATCH THE VIDEO](#)

[CLICK HERE TO VIEW PRODUCT SPECS](#)

BROMIC HEATING

REQUEST YOUR COMPLIMENTARY DESIGN



I've owned this patio heater for more than a year and am very happy with it so far. Unlike the more traditional "mushroom" style standing propane heaters, it directs the heat into a specific direction.

HOMEOWNER

United States

Contact

BROMIC
HEATING

AIA Continuing Education Provider

Expand your expertise in designing outdoor heating projects with our AIA certified online courses.

BROMICUNIVERSITY.COM

UNITED STATES

7595 Irvine Center Drive, Ste. 100
Irvine, California 92618

1 (800) 301-1293

EUROPE

Newtonlaan 115
3584 BH Utrecht
Netherlands

AUSTRALIA

10 Phiney Place
Ingleburn NSW 2565

FOLLOW US:



BROMIC.COM